

**SCHEMATIC**

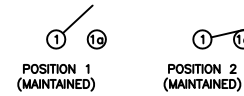

**SPECIFICATIONS**

**FUNCTION:**  
1P1T OFF-ON

**RATINGS:**  
ANSI/UL 1054 and CAN/CSA C22.2 No. 55 (E194579):  
10A 125VAC [UR, cUR]  
EN 61058-1:2002:  
6(2)A 250V~ μ 1E4 T125/55 [ENEC14, SEMKO]

**CONTACT RESISTANCE:**  
Initial: 35mΩ Max. at 50VAC

**INSULATION RESISTANCE:**  
100MΩ Min. at 500VDC

**DIELECTRIC STRENGTH:**  
1,500VAC For 1 Minute

**ELECTRICAL LIFE:**  
6,000 Cycles [UR, cUR]  
10,000 Cycles [ENEC14, SEMKO]

**TEMPERATURE:**  
Operating: -20°C to 105°C [UR, cUR]  
Operating: -20°C to 125°C [ENEC14, SEMKO]

**APPROVALS:**

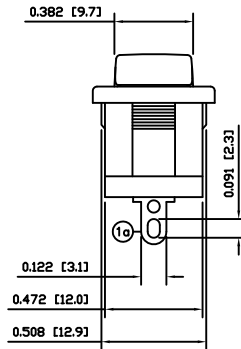
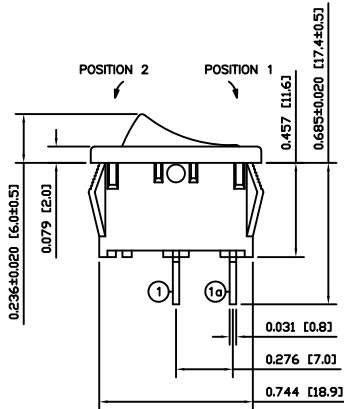
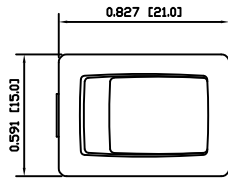

**COLORS AND MARKINGS**

**BODY:**  
Black

**ACTUATOR:**  
Black

**MARKINGS:**  
None

**MARKING COLOR:**  
None

**MATERIALS**

**BODY:**  
Polyamide 6/6 (PA66), UL94 V-2

**ACTUATOR:**  
Polyamide 6/6 (PA66), UL94 V-2

**SPRING:**  
Steel

**BALL:**  
Steel

**MOBILE CONTACT:**  
Silver Alloy

**CONTACTS:**  
Silver Alloy

**TERMINALS:**  
Silver Plated Copper

**SUGGESTED PANEL CUTOUT**

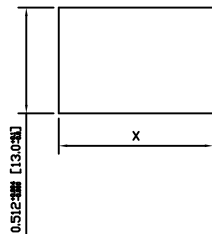

| PANEL THICKNESS |             | X            |
|-----------------|-------------|--------------|
| 0.030~0.049     | [0.75~1.25] | 0.756 [19.2] |
| 0.049~0.079     | [1.25~2.00] | 0.764 [19.4] |
| 0.079~0.118     | [2.00~3.00] | 0.772 [19.6] |

|                |      |          |     |
|----------------|------|----------|-----|
| ACTUATOR       | A    | 09/05/04 | CAB |
| BODY           | A    | 09/05/04 | CAB |
| COLORS         | A    | 09/05/04 | CAB |
| MATERIALS      | A    | 09/05/04 | CAB |
| SPECIFICATIONS | B    | 09/06/13 | CAB |
| REFERENCE      | REV. | DATE     | BY  |

THE INFORMATION CONTAINED IN THIS DOCUMENT IS PROPRIETARY TO E-SWITCH-LAMB INDUSTRIES AND IS NOT TO BE COPIED OR TRANSFERRED

|      |                 |       |          |          |
|------|-----------------|-------|----------|----------|
| A    | INITIAL RELEASE | 19381 | 10/10/22 | CAB      |
| REV. | DESCRIPTION     | PCR   | DATE     | DRAWN BY |

|                      |            |
|----------------------|------------|
| DIMENSIONS           |            |
| INCHES [MILLIMETERS] |            |
| GENERAL TOLERANCES   |            |
| ±0.008 [±0.2] / ±1'  |            |
| SCALE                | PROJECTION |
| DRAWING NOT TO SCALE |            |

|               |                  |          |  |
|---------------|------------------|----------|--|
|               |                  |          |  |
| RA12131100    |                  |          |  |
| ITEM NUMBER   | DATE             | REVISION |  |
| 38-RA12131100 | OCTOBER 22, 2010 | A        |  |